

# Terrco<sup>®</sup>, Inc.

## 151 Border Machine



### **OPERATING INSTRUCTIONS**

### **MAINTENANCE INSTRUCTIONS**

### **ILLUSTRATED PARTS LIST**

**Terrco<sup>®</sup>, Inc.**

222 1st Avenue NW • Watertown, SD 57201

Phone: (605) 882-3888 • Fax: (605) 882-0778 • Email: [info@terrco.com](mailto:info@terrco.com)

# 151 BORDER MACHINE SPECIFICATIONS

1. MOTOR: 3 HP, 230 Volt, 60 Hz
2. STARTER: 1 Phase, Variable Speed
3. GEARS: Alloy steel, beveled cut, heat treated
4. TRUCK WHEELS: Roller bearing, rubber tired
5. SPEED OF GRINDING WHEEL: 0-1760 RPM
6. WATER TANK: 5 gallons
7. LUBRICATION: Wheel bearings only
8. WEIGHT: 151V - 234 lbs. - 106 kg  
151LV - 275 lbs. - 136 kg
9. SHIPPING WEIGHT: 151V - 315 lbs. - 144 kg  
151LV - 340 lbs. - 155 kg
10. ABRASIVE PRESSURE ON STONE: 151V - 70 lbs , 151LV - 90 lbs
11. LENGTH: 151V - 31 inches, 151LV - 43 inches
12. WIDTH: 15 inches
13. HEIGHT: 37 inches
14. ADJSUATBLE CARRIAGE: Carriage adjusts to keep machine level at all times.

## **OPERATING INSTRUCTIONS:**

### **TO INSTALL/REMOVE GRINDING WHEEL:**

1. Disconnect power to the machine.
2. Tip machine back on the rear carrying handle.
3. Use the wrenches provided with machine to remove the stone nut
4. Clean the machine prior to installing a new grinding wheel
5. Install new grinding wheel and tighten stone nut.
6. Adjust guard.
7. Tip machine down to operating position.
8. Adjust carriage height to set grinding wheel square to the floor.

### **TO START/STOP MACHINE:**

1. Connect power to the machine. The Terrco 151V and 151LV will operate most efficiently within the voltage range of 215-230 volts. Number 14-3 rubber cable is the minimum size cable to be used with this machine, if adding cable after the first 100 feet.
2. Start flow from water tank.
3. Lift some of the weight off of the grinding stone and push the start button.
4. To stop the machine, push the stop button.
5. To adjust the speed of the grinding wheel, push the up or down arrows.

## **SAFETY:**

1. Have an electrician hook up power to machine.
2. Always operate machine with ground faults at the electrical source.
3. Always wear appropriate safety protection. Eye, hearing and respiratory protection is advised.
4. Rotating grinding wheels can cause injury, keep hands and loose clothing clear.
5. Service and adjust guard for maximum protection, never remove it.
6. Keep machine clean and serviced.

## **REPAIRS:**

1. Use only Terrco® parts.
2. When ordering parts, have model number, serial number and part numbers.
3. For factory repairs, send the machine to Terrco®, freight pre-paid, with a letter stating problem, name and phone number.

# PARTS DIAGRAM

## "TERRCO - 151"

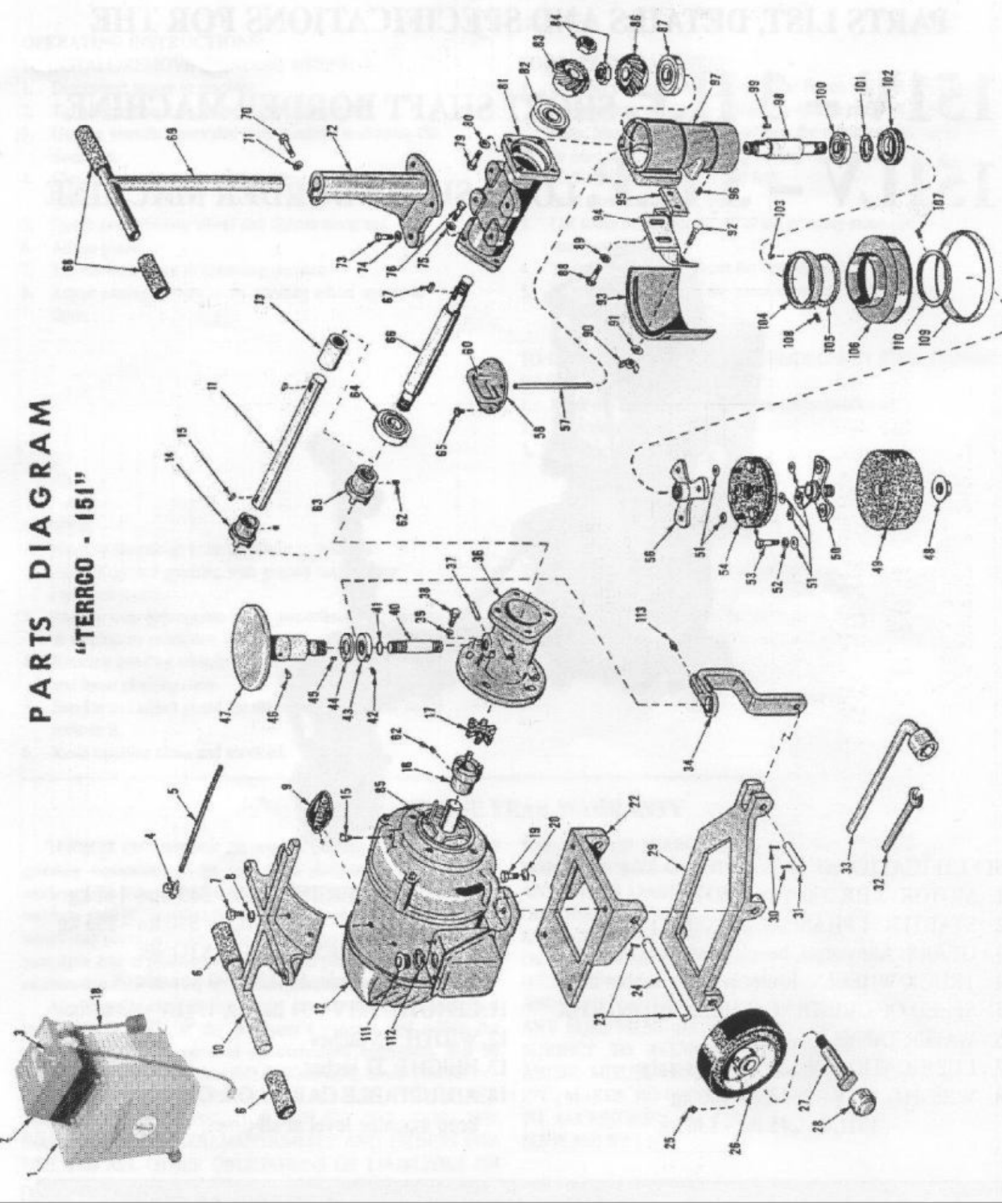

# PARTS LIST

## TERRCO 151LV 3 H.P. LONG SHAFT BORDER MACHINE

## TERRCO 151V 3 H.P. SHORT SHAFT BORDER MACHINE

NOTE: Always give machine serial number and model number when ordering machine parts.

Ref. No.	Part No.	Description	No. Req'd	Ref. No.	Part No.	Description	No. Req'd	Ref. No.	Part No.	Description	No. Req'd
1	HBS-185	WATER TANK	1	40	HBS-122	STUD	1	79	2013	CAP SCREW	4
2	HBS-188	DRIVE, VARI-SPEED	1	41	HBS-130	"O" RING	1	80	1022	LOCK WASHER	4
3	LW-78	EMERGENCY STOP SWITCH	1	42	1053	SET SCREW	1	81	HB-3	HORIZONTAL BEARING HOUSING	1
4	AH-25	PET COCK	1	43	HBS-129	COLLAR	1	82	HB-6	HORIZONTAL HOUSING GEAR BEARING	1
5	HB-41	WATER HOSE (15" LG.)	1	44	HBS-133	WASHER	1	83	HB-24	DRIVE GEAR	1
6	HBS-136	HANDLE GRIPS (REAR)	2	45	HBS-140	WASHER LOCK PUN	1	84	HB-11	ELASTIC JAM NUT	2
7	HBS-135	CAP SCREW	4	46	2010	ALEMITE FITTING	1	85	HB-53	MOTOR SHAFT KEY	1
8	1022	LOCK WASHERS	4	47	HBS-120	ADJUSTMENT HAND WHEEL	1	86	HB-10	DRIVEN GEAR	1
9	HBS-137	"TERRCO" NAME PLATE	1	48	HBS-148	DISC NUT	1	87	HB-6	UPRIGHT HOUSING TOP BEARING	1
10	HBS-121	TANK BRACKET	1	49	2032	GRINDING STONE	1	88	2004	CAP SCREW	2
11	HB-36	DRIVE SHAFT	1	50	HB-9	DRIVEN SPIDER	1	89	1022	LOCK WASHER	2
12	HBS-167	MOTOR 3 H.P.	1	51	HB-25	WASHER	18	90	HBS-131	WING NUT	2
13	HB-37	DRIVING COUPLING	1	52	1022	LOCK WASHER	6	91	2053	WASHER	2
14	HB-119	COUPLING	1	53	1025	CAP SCREW	6	92	2029	CARRIAGE BOLT	2
15	HB-49	WOODRUFF KEY	2	54	HB-26	FLEXIBLE DISC	2	93	HB-32	SPLASH GUARD	1
16	HBS-134	COUPLING (SHORT)	1					94	HB-33	SPLASH GUARD BRACKET	1
17	HBS-119-A	COUPLING INSERT	1	56	HB-8	DRIVE SPIDER	1	95	HB-107	SPLASH GUARD SPACER	1
18	HBM-12	PIGTAIL ASSEMBLY	1	57	HB-12	WATER PIPE	1	96	2026	SET SCREW	1
19	1025	CAP SCREW	4	58	HB-57	BRONZE HANDLE	1	97	HB-2	UPRIGHT BEARING HOUSING	1
20	1022	LOCK WASHER	4	60	SM-66	PIPE NIPPLE	1	98	HB-5	UPRIGHT SHAFT	1
22	HBS-128	PIVOT BRACKET	1					99	HB-54	DRIVE SHAFT KEY	1
23	2022	COTTER PIN	2	62	2026	SET SCREW	2	100	HB-22	UPRIGHT HOUSING BOTTOM BEARING	1
24	HBS-127	SHAFT	1	63	HBS-132	COUPLING (LONG)	1	101	HB-7	FELT WASHER	1
25	AF-80	ALEMITE FITTING	2	64	HB-7	HORIZONTAL HOUSING END BEARING	1	102	HB-23	LOWER BEARING LOCK NUT	1
26	AF-53	CARRIAGE WHEEL	2	65	1031	CAP SCREW	4	103	HB-93	GITS OIL CUP	1
27	HB-45	WHEEL ADJ. SHAFT	2	66	HB-4	DRIVEN SHAFT	1	104	HB-83	BRASS THRUST COLLAR (TOP)	1
28	AF-56	CARRIAGE WHEEL HUB CAP	2	67	HB-54	DRIVEN SHAFT KEY	1	105	HR-90	FELT WASHER	1
29	HBS-126	PIVOT PLATFORM	1	68	HB-30	HANDLE GRIPS	2	106	HB-82	DISC HOUSING	1
30	2022	COTTER PIN	2	69	HB-34	HANDLE	1	107	1059	SET SCREW	3
31	HBS-125	SHAFT	1	70	1025	CAP SCREW	1	108	1059	SET SCREW	3
32	2037	OPEN END WRENCH	1	71	1022	LOCK WASHER	1	109	HB-31	DISC HOUSING RUBBER BUMPER	1
33	2035	"L" WRENCH (LARGE)	1	72	HB-29	HANDLE BASE	1	110	HB-84	BRASS THRUST COLLAR (BOTTOM)	1
34	HB-124	ADJUSTING YOKE	1	73	1025	CAP SCREW	4	111	HBS-169	CORD CONNECTOR	1
36	HB-1	HOUSING - 151LV (LONG SHAFT)	1	74	1022	LOCK WASHER	4	112	HBS-170	CONDUIT NUT	1
38	HBS-123	HOUSING - 151V (SHORT SHAFT)	1	75	1022	LOCK WASHER	4	113	2016	ALEMITE FITTING	1
37	SM-161	ROLL PIN	1	76	1025	CAP SCREW	4	114	HBS-123A	INSPECTION HOLE COVER (NOT SHOWN)	1
38	1025	CAP SCREW	4					115	HB-130	SHIM GEAR SPACING (NOT SHOWN)	1
39	HB-25	LOCK WASHER	4					116	HBS-171	VIBRATION MOUNT (NOT SHOWN)	4

## **WARRANTY CLAIM PROCEDURE**

Each new machine is covered by two separate, distinct warranties—one on the machine and one on the electric motor of gasoline engine. Read **VERY CAREFULLY** the Terrco<sup>®</sup> warranty covering the machine, as this will tell you whether you have a warranty claim or not. If your machine is under warranty and malfunctions, determine whether your problem is electrical or mechanical, and do the following:

### **I. Electrical.**

- A. Consult the list of authorized motor repair stations sent with the machine and locate the station nearest you.
- B. Contact the repair station, giving them the following information:
  - 1. Complete nameplate data from the motor.
  - 2. Tell them that the machine is a terrazzo grinding and polishing machine.
  - 3. Give them a description or rundown of the trouble.
  - 4. Inform them of the voltage and amperage readings as outlined in paragraph II, B, 2 and 3, on page 2 of this manual.

### **II. Mechanical**

- A. Contact your Terrco<sup>®</sup> Distributor giving them the following:
  - 1. Model and date purchased.
  - 2. Horsepower.
  - 3. Accurate description of the malfunction.
- B. If there is no Terrco<sup>®</sup> Distributor in your area call or write to us with the above information.

## **LIMITED ONE YEAR WARRANTY**

TERRCO<sup>®</sup>, Inc. warrants the original purchaser of the Terrco<sup>®</sup> grinding equipment to be free from defects in materials and workmanship under normal use and service. Our obligation under this warranty shall be limited to the repair or exchange of any part or parts which may prove defective under normal use and service within one year from date of purchase by, the original purchaser, and which our examination shall disclose to our satisfaction to be defective.

All equipment returned for repairs or exchange must be returned to: TERRCO<sup>®</sup>, Inc., at the purchaser's expense and within the warranty period. All repaired or exchanged equipment will be shipped back to the purchaser F.O.B. Watertown, South Dakota.

THIS WARRANTY IS EXPRESSLY IN LIEU OF ALL OTHER WARRANTIES EXPRESSED OR IMPLIED INCLUDING THE WARRANTIES OR MERCHANTABILITY AND FITNESS FOR USE AND ALL OTHER OBLIGATIONS OR LIABILITIES ON THE PART OF TERRCO<sup>®</sup>, INC. AND WE NEITHER ASSUME OR AUTHORIZE ANY OTHER PERSON TO ASSUME FOR US, ANY OTHER LIABILITY IN CONNECTION WITH THE SALE OF THIS EQUIPMENT. SOME STATES DO NOT ALLOW THE EXCLUSIONS OR LIMITATIONS ON IMPLIED WARRANTIES OR DO NOT ALLOW THE EXCLUSION OF LIMITATION OF INCIDENTAL OR CONSEQUENTIAL DAMAGES, SO THE ABOVE EXCLUSIONS OR LIMITATIONS MAY NOT APPLY TO YOU. THIS WARRANTY SHALL NOT APPLY TO ANY EQUIPMENT OR PART THEREOF WHICH HAS BEEN SUBJECT TO ACCIDENT, NEGLIGENCE, ALTERATIONS, ABUSE, MISUSE, OR IMPROPER MAINTENANCE. TERRCO<sup>®</sup>, INC. MAKES NO WARRANTIES WHATSOEVER IN RESPECT TO ACCESSORIES OR PARTS NOT MANUFACTURED OR SUPPLIED BY US.